

\$56,000 - Lot 2 Blk 2 Lake Country Estate, Rural Athabasca County

MLS® #A2113717

\$56,000

0 Bedroom, 0.00 Bathroom,
Land on 2.95 Acres

Lake Country Estates, Rural Athabasca
County, Alberta

A fantastic opportunity to own 2.95 Acres of LAND in Lake Country Estates close to Boyle and many lakes. Build your dream home or make it your very own oasis of a recreational get away. GOT TO LOVE HAVING OPTIONS!! There are only 3 LOTS left so don't miss out! This LOT is fully treed and is located West of Boyle on HWY 63. Only 20 Min away from Skeleton Lake and Golf course also Long Lake and golf course. This area is known for surrounded lakes, quadding, trails, boating, swimming, golfing, boating, skidooing and a beautiful community spirit in our village of Boyle. 1.5 hrs from Edmonton and 2.5 hrs from Fort McMurray. ACT NOW!!!

Essential Information

MLS® #	A2113717
Price	\$56,000
Bathrooms	0.00
Acres	2.95
Type	Land
Sub-Type	Residential Land
Status	Active

Community Information

Address	Lot 2 Blk 2 Lake Country Estate
Subdivision	Lake Country Estates

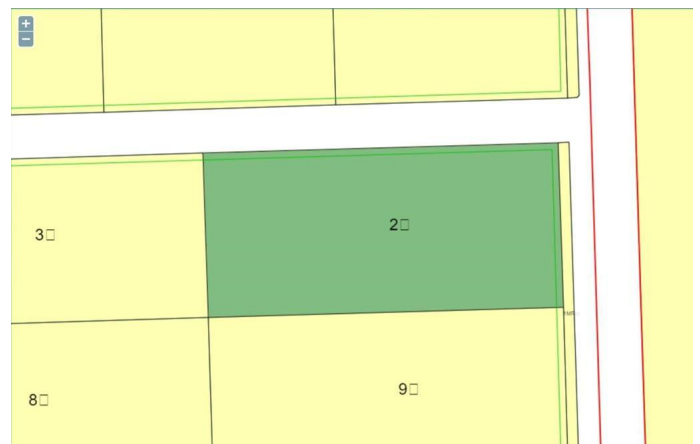

City	Rural Athabasca County
County	Athabasca County
Province	Alberta
Postal Code	T0A0M0

Additional Information

Date Listed	March 11th, 2024
Days on Market	404
Zoning	RES

Listing Details

Listing Office	RE/MAX Connect
----------------	----------------

Data is supplied by Pillar 9â„¢ MLS® System. Pillar 9â„¢ is the owner of the copyright in its MLS® System. Data is deemed reliable but is not guaranteed accurate by Pillar 9â„¢. The trademarks MLS®, Multiple Listing Service® and the associated logos are owned by The Canadian Real Estate Association (CREA) and identify the quality of services provided by real estate professionals who are members of CREA. Used under license.